



National Geographic Quest & National Geographic Venture

CAPACITY: 100 guests in 50 outside cabins.

REGISTRY: United States. **OVERALL LENGTH:** 238 feet.

Sister ships *National Geographic Quest* and *National Geographic Venture* are designed with over 50 years of expedition heritage and built in the U.S.A. Both ships set a new standard in exploration and comfort.

PUBLIC AREAS: Global gallery; fitness center; LEXspa; lounge with full service bar and facilities for films and presentations; observation deck; mudroom with lockers for expedition gear, and a partially covered sundeck with chairs and tables. Our “open Bridge” provides guests an opportunity to meet our officers and captain and learn about navigation.

MEALS: Served in a single seating with unassigned tables. The menu features locally inspired fare.

CABINS: All cabins face outside with windows or portholes, private facilities and climate controls. Category 4 cabins have step-out balconies.

EXPEDITION EQUIPMENT: A fleet of 8 Zodiacs and 24 kayaks, paddleboards, Remotely Operated Vehicle (ROV), hydrophone, splash-cam, underwater video camera, video microscope, snorkeling gear and wet suits for all guests (where applicable), and OM System Photo Gear Locker.

SPECIAL FEATURES: Guest internet access, elevator, certified photo instructor, video chronicler and undersea specialist.

WELLNESS: The vessel is staffed by a Wellness Specialist and features a gym with an elliptical machine, treadmill, exercycles, handweights and resistance bands. Treatments in the LEXspa are available by appointment.



From top: Enjoy expansive views and regional fare in the informal dining room; gather to watch for wildlife or enjoy an evening cocktail with friends in the open air, partially covered sun deck.



Clockwise above: the lounge, with 270° views, is the hub of the expedition community; Category 5 cabin is our most spacious; Category 4 cabin with single beds (which can be converted to queen) and private step-out balcony.

CATEGORY 1: Main Deck #301-306 Cabins face outside with two portholes, feature two single beds that can convert to a queen, a writing desk, two nightstands, full length mirror and a closet.

CATEGORY 2: Main Deck #307-315 Cabins face outside with two portholes, feature two single beds that can convert to a queen, a writing desk, two nightstands, full length mirror and a closet.

CATEGORY 3: Upper Deck #201-206 Cabins face outside with a large window, feature two single beds that can convert to a queen, a writing desk, two nightstands, full length mirror and a closet.

CATEGORY 4: Upper Deck #207-229 Cabins face outside with a sliding glass door and small private balcony, feature two single beds that can convert to a queen, a writing desk, two nightstands, full length mirror and a closet.

CATEGORY 5 (SUITE): Observation Deck #101-108 Cabins face outside with a large view window, feature two single beds that can convert to a queen, a writing desk, two nightstands, full length mirror, convertible sofa bed to accommodate a third person, expanded bathroom and extra closet space.

NOTE: Solo Occupancy cabins are available in Categories 1 and 2 only. Third person rates are available in Category 5 cabins at one half the double occupancy rate.

Connecting Cabins via internal doorway access: Main Deck: #312-314, #311-315, #306-308, #305-307; Upper Deck: #224-226, #225-227



OBSERVATION DECK

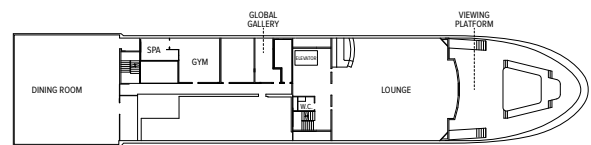

LOUNGE DECK



UPPER DECK



MAIN DECK

TREATMENT ROOM